

Bohrfutter

QUICK CHANGE DRILL HOLDERS

ART. L030

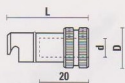

For: **BIESSE**

| RH rotation | LH rotation | d | D | L |
|-------------|---------------------|-----|----|----|
| L030.100.R | L030.100.L | 10 | 20 | 37 |
| L030.101.R | L030.101.L lowered | 10 | 20 | 30 |
| L030.102.R | L030.102.L threaded | M10 | 20 | 37 |



Z051.314.R

QUICK CHANGE DRILL HOLDERS

ART. L031

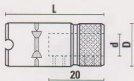

For: **MORBIDELLI**

| RH rotation | LH rotation | d | D | L |
|-------------|---------------------|-----|----|----|
| L031.100.R | | 10 | 20 | 43 |
| L031.101.R | lowered | 10 | 16 | 43 |
| L031.102.R | L031.102.L threaded | M10 | 20 | 43 |



Z051.314.R
(L031.100.R)



Z051.313.R
(L031.101.R)

QUICK CHANGE DRILL HOLDERS

ART. L032

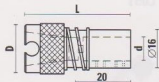

For: **MORBIDELLI** machines, with pull out spring

| Item | d | D | L |
|------------|----|----|----|
| L031.500.R | 10 | 20 | 44 |



Z051.301.R

ADAPTORS

ART. L031

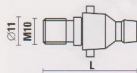

- Adaptor for quick change chucks
- For: **MORBIDELLI**, **SCM** with shank **M10/11**
- Use with: Art. L031.100.R and/or Art. L031.500.R

| RH rotation | LH rotation | L |
|-------------|-------------|----|
| L031.600.R | L031.600.L | 37 |

QUICK CHANGE DRILL HOLDERS

ART. L032

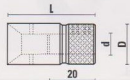

For: **MASTERWOOD**, **MAGGI**, **GRIGGIO**

| Item | d | D | L |
|------------|----|----|----|
| L032.100.R | 10 | 20 | 40 |

For: **MINIMAX**

| Item | d | D | L |
|-----------------------|----|----|----|
| L032.200.R NEW | 10 | 20 | 40 |



Z051.301.R

QUICK CHANGE DRILL HOLDERS

ART. L033

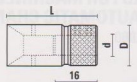

For: **VITAP**

| Item | d | D | L |
|------------|----|----|----|
| L033.100.R | 10 | 18 | 42 |



Z051.313.R

Bohrfutter

QUICK CHANGE DRILL HOLDERS

ART. L034

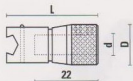

For: BUSELLATO

| Item | d | D | L |
|------------|----|----|------|
| L034.100.R | 10 | 19 | 34,5 |



Z051.313.R

QUICK CHANGE DRILL HOLDERS

ART. L035

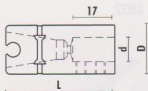

For: DETEL

| Item | d | D | L |
|------------|----|----|----|
| L035.100.R | 10 | 20 | 45 |



Z051.314.R

QUICK CHANGE DRILL HOLDER

ART. L036

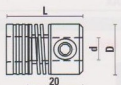

For: GRASS

| Item | d | D | L |
|------------|----|----|------|
| L036.100.R | 10 | 22 | 38,5 |



Z051.304.R

CHUCKS FOR MACHINES "BIESSE" WITH AUTOMATIC CHANGE

ART. L060

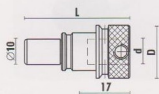

| Item | d | D | L |
|------------|----|----|----|
| L060.100.N | 10 | 21 | 42 |



Z051.314.R

QUICK CHANGE DRILL HOLDERS

ART. L040

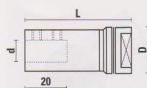

For: WEEKE

| Item | d | D | L |
|------------|----|----|----|
| L040.100.R | 10 | 20 | 46 |
| L040.101.R | 10 | 20 | 56 |
| L040.102.R | 10 | 20 | 66 |



Z051.314.R

QUICK CHANGE CHUCKS

ART. L050

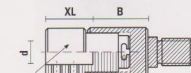
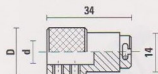

L050.100.N

For art: L051 - L052 - L053 - L054

| Item | d | D | XL |
|------------|----|----|------|
| L050.100.N | 10 | 18 | 17,5 |



Z051.301.R

QUICK CHANGE CHUCKS

ART. L051

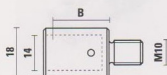

For: AYEN, HOLZMA

| RH rotation | LH rotation | B |
|-------------|-------------|------|
| L051.100.R | L051.100.L | 22,5 |

DRILL ADAPTORS

ART. L001 - M10/11x4

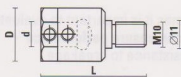

For: MORBIDELLI, BIESSE, WEEKE

| RH rotation | LH rotation | d | D | L |
|-------------|-------------|----|------|----|
| L001.080.R | L001.080.L | 8 | 15,5 | 41 |
| L001.100.R | L001.100.L | 10 | 19,5 | 41 |



Z051.301.R

DRILL ADAPTORS

ART. L002 - M10/Taper 30°

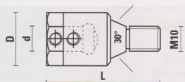

For: VITAP, BUSELLATO, SCHLEICHER

| RH rotation | LH rotation | d | D | L |
|-------------|-------------|----|------|----|
| L002.080.R | L002.080.L | 8 | 15,5 | 46 |
| L002.100.R | L002.100.L | 10 | 19,5 | 46 |



Z051.301.R

DRILL ADAPTORS

ART. L003 - M10

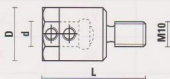

For: AYEN, HOLZMA, MAYER

| RH rotation | LH rotation | d | D | L |
|-------------|-------------|----|------|----|
| L003.080.R | L003.080.L | 8 | 15,5 | 40 |
| L003.100.R | L003.100.L | 10 | 19,5 | 40 |



Z051.301.R

DRILL ADAPTORS

ART. L004 - M8/9x3

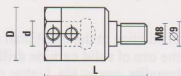

For: MORBIDELLI, NOTTMEYER

| RH rotation | LH rotation | d | D | L |
|-------------|-------------|----|------|----|
| L004.080.R | L004.080.L | 8 | 15,5 | 41 |
| L004.100.R | L004.100.L | 10 | 19,5 | 41 |
| L004.101.R | L004.101.L | 10 | 15 | 41 |



Z051.301.R

DRILL ADAPTORS

ART. L005 - M8

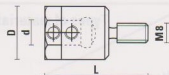

For: NOTTMEYER

| RH rotation | LH rotation | d | D | L |
|-------------|-------------|----|------|----|
| L005.080.R | L005.080.L | 8 | 15,5 | 40 |
| L005.100.R | L005.100.L | 10 | 19,5 | 40 |



Z051.301.R

DRILL ADAPTORS

ART. L006 - M8 - 20°48'

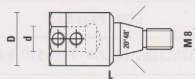

For: BILEK

| RH rotation | LH rotation | d | D | L |
|-------------|-------------|----|------|----|
| L006.080.R | L006.080.L | 8 | 15,5 | 51 |
| L006.100.R | L006.100.L | 10 | 19,5 | 51 |



Z051.301.R

Bohrfutter und passende Standardbohrer

QUICK CHANGE CHUCKS

ART. L052

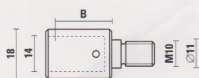

For: MORBIDELLI, BIESSE, WEEKE, BUSELLATO, TORWEGGE

| RH rotation | LH rotation | B |
|-------------|-------------|------|
| L052.100.R | L052.100.L | 22,5 |

QUICK CHANGE CHUCKS

ART. L053

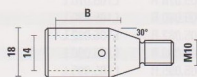

For: VITAP, ALBERTI

| RH rotation | LH rotation | B |
|-------------|-------------|------|
| L053.100.R | L053.100.L | 25,5 |

QUICK CHANGE CHUCKS

ART. L054

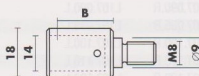

For: NOTTMEYER

| RH rotation | LH rotation | B |
|-------------|-------------|------|
| L054.100.R | L054.100.L | 25,5 |

HW DOWEL DRILLS Z=2

ART. L101 - L102

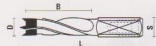

- 4-flutes
- Spurs ground with negative cutting angle for a good finish
- PTFE-Based coating for a better chip flow
- For natural wood, pressed wood, veneered, chipboard, laminated and MDF
- Can be used on Mafell drilling machines

| RH rotation | LH rotation | D | B | L | S |
|-------------|-------------|----|----|------|------|
| L101.050.R | L101.050.L | 5 | 30 | 55,5 | 8X20 |
| L101.060.R | L101.060.L | 6 | 30 | 55,5 | 8X20 |
| L101.070.R | L101.070.L | 7 | 30 | 55,5 | 8X20 |
| L101.080.R | L101.080.L | 8 | 30 | 55,5 | 8X20 |
| L101.090.R | L101.090.L | 9 | 30 | 55,5 | 8X20 |
| L101.100.R | L101.100.L | 10 | 30 | 55,5 | 8X20 |
| L101.120.R | L101.120.L | 12 | 30 | 55,5 | 8X20 |
| L102.050.R | L102.050.L | 5 | 40 | 67 | 8X20 |
| L102.060.R | L102.060.L | 6 | 40 | 67 | 8X20 |
| L102.070.R | L102.070.L | 7 | 40 | 67 | 8X20 |
| L102.080.R | L102.080.L | 8 | 40 | 67 | 8X20 |
| L102.090.R | L102.090.L | 9 | 40 | 67 | 8X20 |
| L102.100.R | L102.100.L | 10 | 40 | 67 | 8X20 |
| L102.120.R | L102.120.L | 12 | 40 | 67 | 8X20 |



Z051.302.R

HW THROUGH HOLES DRILL BITS Z=2

ART. L121 - L122

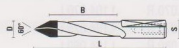

- 2-flutes
- PTFE-Based coating for a better chip flow
- For natural wood, pressed wood, veneered, chipboard, laminated and MDF

| RH rotation | LH rotation | D | B | L | S |
|-------------|-------------|---|----|------|------|
| L121.050.R | L121.050.L | 5 | 25 | 55,5 | 8X20 |
| L121.080.R | L121.080.L | 8 | 25 | 55,5 | 8X20 |
| L122.050.R | L122.050.L | 5 | 35 | 67 | 8X20 |
| L122.080.R | L122.080.L | 8 | 35 | 67 | 8X20 |



Z051.302.R